

THIS COPY IS PROVIDED ON A RESTRICTED BASIS AND IS NOT TO BE USED IN ANY WAY DETRIMENTAL TO THE INTERESTS OF PANDUIT CORP.

NOTES:

1. VISIT OUR ON-LINE CATALOG AT WWW.PANDUIT.COM FOR A LIST OF CURRENT PARTS APPLICABLE FOR USE WITH THIS PRODUCT.
2. DIMENSIONS IN [] ARE METRIC.
3. ALL MATERIALS AND COMPONENTS USED MEET THE MATERIAL RESTRICTIONS OF RoHS (EUROPEAN DIRECTIVE 2011/65/EU ON THE RESTRICTION OF HAZARDOUS SUBSTANCES) AS PROPOSED BY THE RoHS TECHNICAL ADAPTATION COMMITTEE.
4. TOP AND BOTTOM CLEAT PARTS ARE 316 STAINLESS STEEL. FASTENERS AND PINS ARE 18-8SS.
5. MEETS IEC 61914:2015 SPECIFICATIONS.
6. MOUNTING FASTENERS ARE NOT INCLUDED IN THE PACKAGE AND MUST BE PURCHASED SEPARATELY.
7. SELECT M8 CARRIAGE BOLT LENGTH SUITABLE FOR THE RUNG
8. CABLE CLEAT BRACKET, PART NUMBER CBH##L##-V6, IS SOLD SEPARATELY.
9. CONTACT PANDUIT SALES FOR CUSTOMIZED SOLUTIONS.

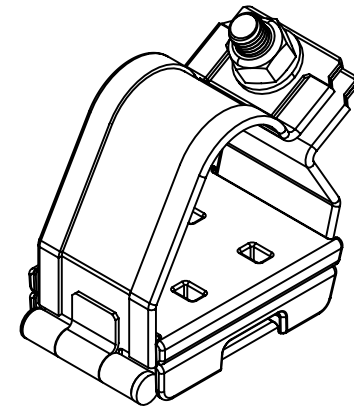

PANDUIT CABLE CLEAT ASSEMBLY
FOR CABLE TREFOIL CONFIGURATIONS

PART NUMBER	CABLE DIAMETER RANGE in. [mm]	"H" in. [mm]	"W" in. [mm]	"D" in. [mm]	WEIGHT lb [g]	MOUNTING HOLES
CCSSTR2025-X	0.79-0.98 [20-25]	3.43 [87]	3.39 [86]	2.48 [63]	0.92 [417]	1 X M8
CCSSTR2328-X	0.91-1.10 [23-28]	3.58 [91]	3.54 [90]	2.48 [63]	0.97 [439]	1 X M8
CCSSTR2632-X	1.02-1.26 [26-32]	3.74 [95]	3.82 [97]	2.48 [63]	1.06 [480]	1 X M8
CCSSTR3036-X	1.18-1.42 [30-36]	3.94 [100]	4.13 [105]	2.48 [63]	1.14 [518]	1 X M8
CCSSTR3440-X	1.34-1.58 [34-40]	4.25 [108]	4.37 [111]	2.48 [63]	1.21 [547]	1 X M8
CCSSTR3844-X	1.50-1.73 [38-44]	4.25 [108]	4.69 [119]	2.48 [63]	1.28 [581]	1 X M8
CCSSTR4248-X	1.65-1.89 [42-48]	4.41 [112]	4.96 [126]	2.48 [63]	1.35 [613]	1 X M8
CCSSTR4652-X	1.81-2.05 [46-52]	4.61 [117]	5.24 [133]	2.48 [63]	1.43 [647]	1 X M8
CCSSTR5057-X	1.97-2.24 [50-57]	4.84 [123]	5.63 [143]	2.48 [63]	1.51 [686]	1 X M8
CCSSTR5461-X	2.13-2.40 [54-61]	5.12 [130]	5.91 [150]	2.48 [63]	1.59 [720]	1 X M8
CCSSTR5865-X	2.28-2.56 [58-65]	5.43 [138]	6.18 [157]	2.48 [63]	1.66 [754]	1 X M8
CCSSTR6269-X	2.44-2.72 [62-69]	5.71 [145]	6.50 [165]	2.48 [63]	1.72 [782]	1 X M8

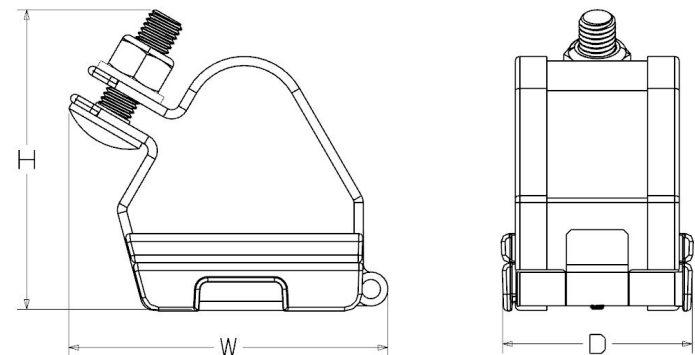

TITLE					
STAINLESS STEEL TREFOIL CABLE CLEAT					
CUSTOMER DRAWING					
ITEM REVISION NAME			00017EKZ/00		
DATASET FILE NAME			00017EKZ/00_DC		
			THIRD ANGLE PROJECTION		
MATERIAL			316 STAINLESS STEEL		
DRAWING NUMBER			00017EKZ_DC		
DRAWN BY	DATE	CHK	SCALE	SIZE	
ACC	7/27/18	RGRO	NONE	A	
SHEET 1 OF 1					