

Keystone All Metal Shielded Modular Patch Panels

specifications

All metal modular patch panels shall be made of cold rolled steel and mount to standard racks and cabinets. All metal patch panels shall accept all Keystone Shielded Jack Modules for shielded installations. Patch Panels shall include label packets and clear plastic window for easy and clear port identification. The all metal modular patch panels shall be available in standard flat 24-port densities. Patch Panels shall incorporate built-in strain relief bar with unique features to support individual cables.



Keystone Flat All Metal Shielded Modular Patch Panels with Strain Relief Bar

24-port, 1 RU: KP24WSRBL

Keystone Shielded Jack Modules

Category 6A: KJS6X88TC

technical information

Mounting option: Mounts to standard EIA 19" rack, or 23" rack when used with extender brackets (PEB1) or cabinet

Packaging: Includes 25 cable ties, 1 18awg ground wire, 1 M3-0.5 X 5mm zinc screw and 4 mounting screws, washers and nuts

Material: Steel

key features and benefits

Modular Keystone Shielded Jack Modules snap in and out of all Keystone All Metal Shielded Modular Patch Panels for easy moves, adds, and changes

Identification Dedicated areas allow for port and panel identification. Labels are covered in a clear plastic window to protect against wear and the elements

Built-in strain relief bar Secures individual cables and provides proper cable support

applications

The Keystone All Metal Shielded Modular Patch Panel includes a built-in strain relief bar that offers integrated cable tie slots to manage and support individual cables. Keystone Shielded Jack Modules bond to the panel when

snapped into a Keystone All Metal Shielded Modular Patch Panel. The Keystone Shielded Patch Panel comes with a 400mm 18AWG ground wire. The combination of all metal patch panels, shielded jack modules and accessories provides a properly grounded system.

Keynote All Metal Shielded Modular Patch Panels

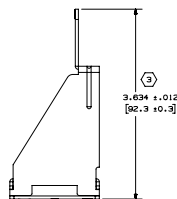
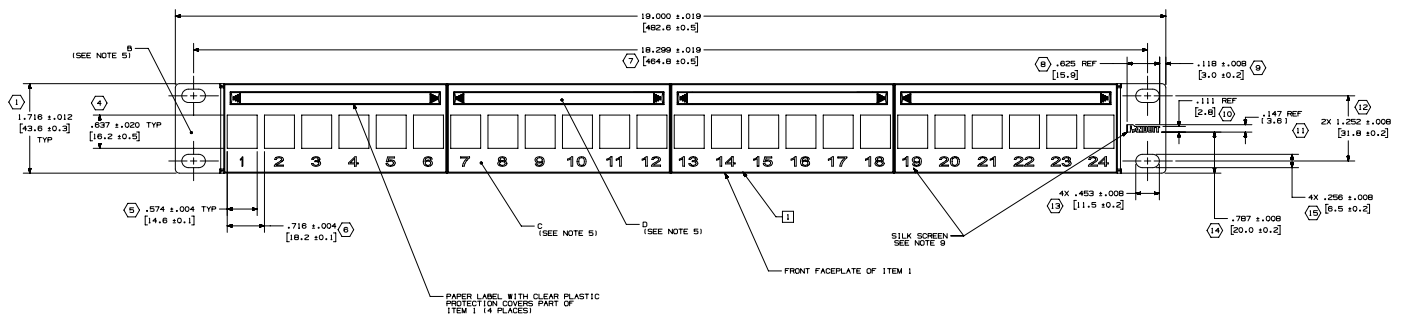
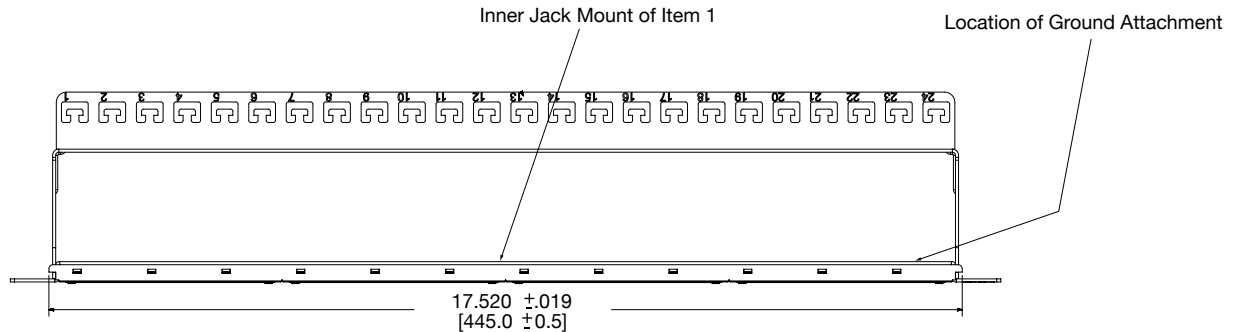

Dimensions are in inches [Dimensions in brackets are metric]

WORLDWIDE SUBSIDIARIES AND SALES OFFICES

PANDUIT CANADA
Markham, Ontario
cs-cdn@panduit.com
Phone: 800.777.3300

PANDUIT EUROPE LTD.
London, UK
cs-emea@panduit.com
Phone: 44.20.8601.7200

PANDUIT SINGAPORE PTE. LTD.
Republic of Singapore
cs-ap@panduit.com
Phone: 65.6305.7575

PANDUIT JAPAN
Tokyo, Japan
cs-japan@panduit.com
Phone: 81.3.6863.6000

PANDUIT LATIN AMERICA
Guadalajara, Mexico
cs-la@panduit.com
Phone: 52.33.3777.6000

PANDUIT AUSTRALIA PTY. LTD.
Victoria, Australia
cs-aus@panduit.com
Phone: 61.3.9794.9020

For a copy of Panduit product warranties, log on to www.panduit.com/warranty

For more information

Visit us at www.panduit.com

Contact Customer Service by email: cs@panduit.com
or by phone: 800.777.3300

PANDUIT

©2018 Panduit Corp.
ALL RIGHTS RESERVED.
COSP319--WW-ENG
Replaces WW-COSP56
10/2018